



SUPER
塑寶牌

塑寶®

可空轉

SP型立式耐酸鹼泵浦

WET/DRY RUNNING VERTICAL PUMPS



SUPER PUMPS

SP

Single impeller、單葉輪、Single dry seal、單軸封

SP 泵是可靠的泵，馬達全部的馬力經由軸心完全轉化為抽送的動力，此型泵浦廣泛地應用於從化學藥水循環到加工模組等各種用途，如果泵浦空轉時，沒有軸封或襯套會損壞，直立型的設計依結構材料的不同，可用於最高流體溫度75°C(167°F)到85°C(185°F)，而且可處理腐蝕力最強的各種溶液，SP 泵是設計來做槽內或加工模組之用，但一定要依安裝高度之規定來安裝，除了1/6~1/8HP 之外，所有其他規格均有一個通氣槽在泵浦座上，以及一個乾式軸封，因此防止酸氣滲透到馬達軸泵。

The SP Series pumps are dependable pumps. The full motor horsepower is translated into pumping power via the shaft. These pumps are used in a wide range of applications from chemical recirculation to process modules. There are no seals or bushings that can be damaged if the pumps run dry. The vertical design has a maximum fluid temperature of 167°F(75°C) to 185°F(85°C), depending on the materials of construction, and can handle the most abrasive solutions. The SP series pumps are designed to run inside of the tank or process module. Except SP1/8~1/6HP, all the rest models have a slotted air gap in the pump base and a dry vapor seal, thereby preventing chemicals penetrating to the motor bearings.



所有本公司三相電源的泵浦都有軸心鍵，當電源接反的時候，葉輪不會掉落，排除了可能對葉輪，罩殼及乾式軸封的損壞。

All 3 phase pumps from Super have a keyed impeller shaft that eliminates the possibility of damage to the impeller, housing or vapor seal if the power is reversed. The impeller will not fall off.

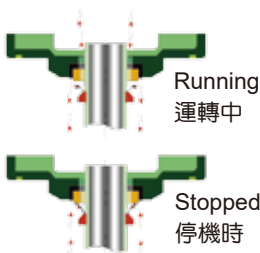

當泵浦運轉中，單乾式軸封因離心力而打開，如此會排除磨擦及密封液體，當泵浦停機時，乾式軸封閉合歸位，以防止酸氣或液體接觸到馬達或軸承。The unique vapor seal is opened by centrifugal force when pump is operating. This eliminates friction and seal wear. The seal closes back up when the pump shuts down to prevent vapor or liquid reaching the motor face or bearings.

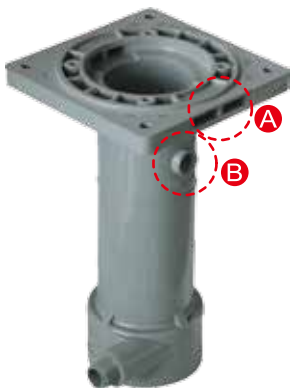

A 排氣槽搭配頂部的乾式軸封，安全地將有酸鹼氣體散掉，而不會接觸軸心及馬達軸承。

Vent slots slign (vapor seal cover) with the seal above to safely disperse contaminates away from the shaft and motor bearings.

B 此溢流孔泵在槽內設計，使用時應不可堵住這個排放孔，使停車反壓時藥水能從此孔排放液體。

For in-tank applications, the vent hole must be open for back-flow to run through when pump shut down.



此配件可安裝於泵出口端配管拆解容易，依藥水不同有 CPVC、FRPP、CFRPP、PVDF。

This elbow-union can be connected to the outlet for easy plumbing. CPVC,FRPP,CFRPP,PVDF materials are available.

MODEL IDENTIFICATION

型號說明

SP - 40 SK 1 6 - V F I S
1 2 3 4 5 6 7 8 9

- | | | |
|--|---|--|
| <p>(1) Type 機型編號
-SP</p> <p>(2) In/Outlet Dia.
出口口徑
20 - 3/4" 25 - 1"
40 - 1-1/2"</p> <p>(3) Sp.Gravity 比重
SK - 1.1 SP - 1.4
SL - Low Rpm 4p
低轉速4P</p> | <p>(4) Power 馬力
1/8-1/8HP 1/6-1/6HP
1/2-1/2HP 1/4-1/4HP
1-1 HP 1/3-1/3HP
2-2 HP</p> <p>(5) Frequency 頻率
5:50Hz 6:60Hz</p> <p>(6) O-Rings O環
V-VITON. N-NBR.
E-EPDM.</p> | <p>(7) Pump Material 泵體材質
F - FRPP K - PVDF
C - CPVC P - CFRPP</p> <p>(8) Internal Installation
I-槽內安裝
External Installation
O-槽外安裝</p> <p>(9) Model 規格
S-Special/特殊規格
N-Standard/標準規格</p> |
|--|---|--|

- 採用FRPP, CPVC, CFRPP, PVDF各種塑鋼材料射出成型可抵抗大部份的化學性，耐酸，耐鹼。
- 適合各種酸鹼液循環，冷卻，噴洗設備，廢氣塔使用。
- 可空運轉使用，絕不因空運轉而損壞。
- 配合本公司獨特設計之由任接頭可方便長久維修保養。
- 主體部份採用C型扣環密封，入口主體體積較小適合槽內式設計使用。
- SP型1/2~2HP機種有乾式軸封設計，馬達前後蓋體均有油封密封來保護軸承。

- Molded parts are out of FRPP,CPVC,CFRPP, PVDF applicable for various chemicals.
- Suitable for chemical circulation, cooling,spraying and scrubber applications.
- Can run-dry without damage.
- Combined with our unique elbow- union,easy to maintain.
- Snap ring secures the inlet and reduces the pump head for in tank applications.
- Single vapor seal on SP1/2~2HP models prevents corrosive vapors from entering the bearing.

SPECIFICATIONS PERFORMANCE CHART

規格/性能曲線

※ 重量/性能以實物為準

Weight / Performance Is For Reference Only Actual Product May Vary

(測試流體：水 比重1.0)

Test Fluid : Water Sp.Gravity 1.0

Model 型式	SP.G 比重	In/Outlet 進出口徑 (mm)	Power 馬力			50Hz			60Hz			Weight 重量kg (參考值)
			Phase 相數	HP	Pole 極數	Curve 曲線	Max.Head 全揚程 M	Max.Flow 全流量 L/min	Curve 曲線	Max.Head 全揚程 M	Max.Flow 全流量 L/min	
20SK-1/8	1.0	25X20	1ø	1/8	2	a	4	28	A	5	48	6
20SK-1/6	1.0	25X20	1ø	1/6	2	b	4	32	B	6	53	6
20SK-1/4	1.0	25X20	1ø/3ø	1/4	2	c	6	70	C	8.5	60	14
25SK-1/3	1.0	25X25	1ø/3ø	1/3	2	d	6.5	80	D	9.5	70	15
25SK-1/2	1.0	40X25	1ø/3ø	1/2	2	e	11	120	E	12	130	19
40SK-1	1.0	50X40	3ø	1	2	f	12	210	F	13	265	20
40SK-2	1.0	50X40	3ø	2	2	g	19	300	G	19	300	24
20SP-1/6	1.3	25X20	1ø	1/6	2	a	4	28	H	4	32	6
25SP-1/3	1.3	25X25	1ø/3ø	1/3	2	c	6	70	C	8	85	15
25SP-1	1.3	40X25	3ø	1	2	i	11	200	I	12	185	20
40SP-1	1.3	50X40	3ø	1	2	j	10	230	J	11	230	20
40SP-2	1.3	50X40	3ø	2	2	k	16.5	320	K	15	280	24
40SL-1/2	1.4	50X40	3ø	1/2	4	l	5	270	L	7	320	19

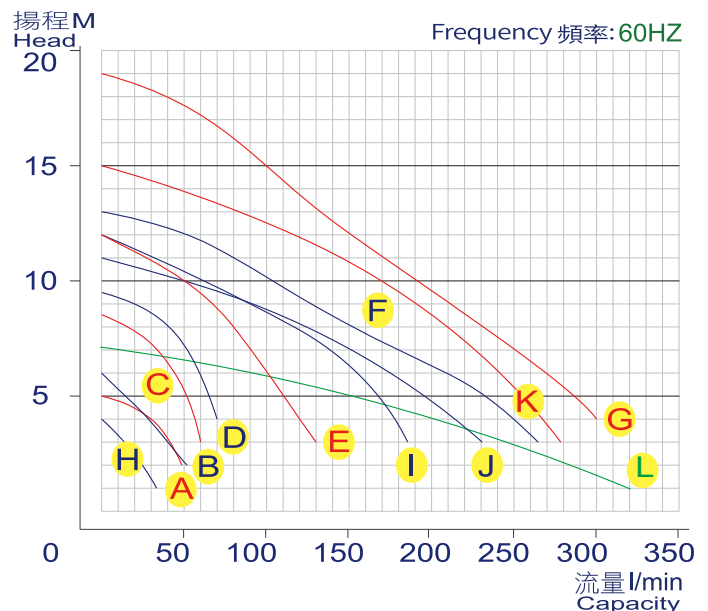
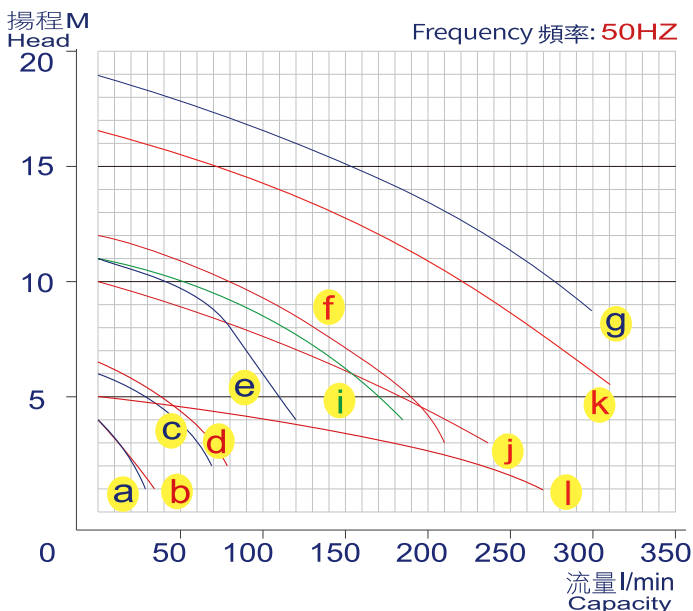

SP

Single impeller、單葉輪、Single vapor seal、單軸封

SP-1/8-1/6HP

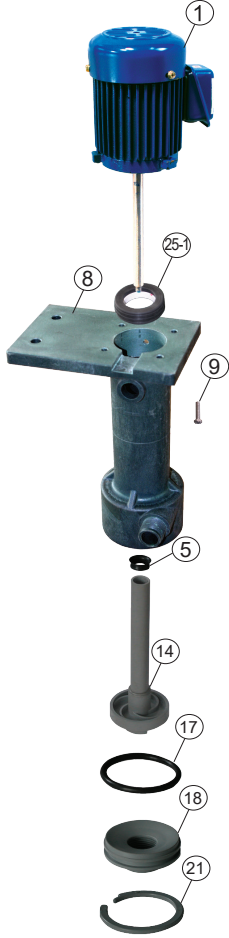

part 14 Impeller Molded impeller with a full length shaft sleeve that eliminates solution contact.
零件14 葉輪，射出成型之葉輪帶有全長軸套，可避免溶液接觸。



出口彎頭/Elbow union
SP/SPT 出口配件

SP-1/4-1/3HP



part 5 Dry seal The unique vapor seal is opened by centrifugal force when pump is operating. This eliminates friction and seal wear. The seal closes back up when the pump shuts down to prevent vapor or liquid reaching the motor face or bearings.
第5項乾式密封泵運行時，獨特的蒸汽密封通過離心力打開。這消除了摩擦和密封件磨損。當泵停機時，軸封向上回復閉合，以防止蒸汽或液體進入電機表面或軸承。



SP-1/2-2HP



part 25 Ceramic seal Ceramic seal surface for the vapor seal.
零件25 陶瓷軸封，乾式軸封用的陶瓷面。



CONSTRUCTION

零件圖表

1 馬達 Motor  FC/Alu	5 乾式軸封 Dry Seal  NBR/VITON	8 主體 Body  FRPP/CFRPP CPVC/PVDF	9 主體固定螺絲 Body Bolt  SUS/Titanium	14 葉輪 Impeller  FRPP/CFRPP CPVC/PVDF	17 前蓋O環 Front Cover O-ring  NBR/VITON/ EPDM	18 前蓋 Front Cover  FRPP/CFRPP CPVC/PVDF	21 C型扣環 C-clip  FRPP/CFRPP CPVC/PVDF	24 軸封蓋 Dry Seal Cover  FRPP/PVDF	25 陶瓷固定環 Ceramic Stationary Ring  Ceramic/NBR
25-1 陶瓷墊片 Ceramic Gasket  NBR	25-2 陶瓷 Ceramic  Ceramic	26 軸封蓋O環 Dry Seal Cover O-ring  NBR/VITON /EPDM	27-1 葉輪固定螺絲 O環/Impeller Screw O-ring  NBR/VITON /EPDM	27-2 葉輪固定螺絲 Impeller Screw  PVDF					

DIMENSIONS

外觀尺寸

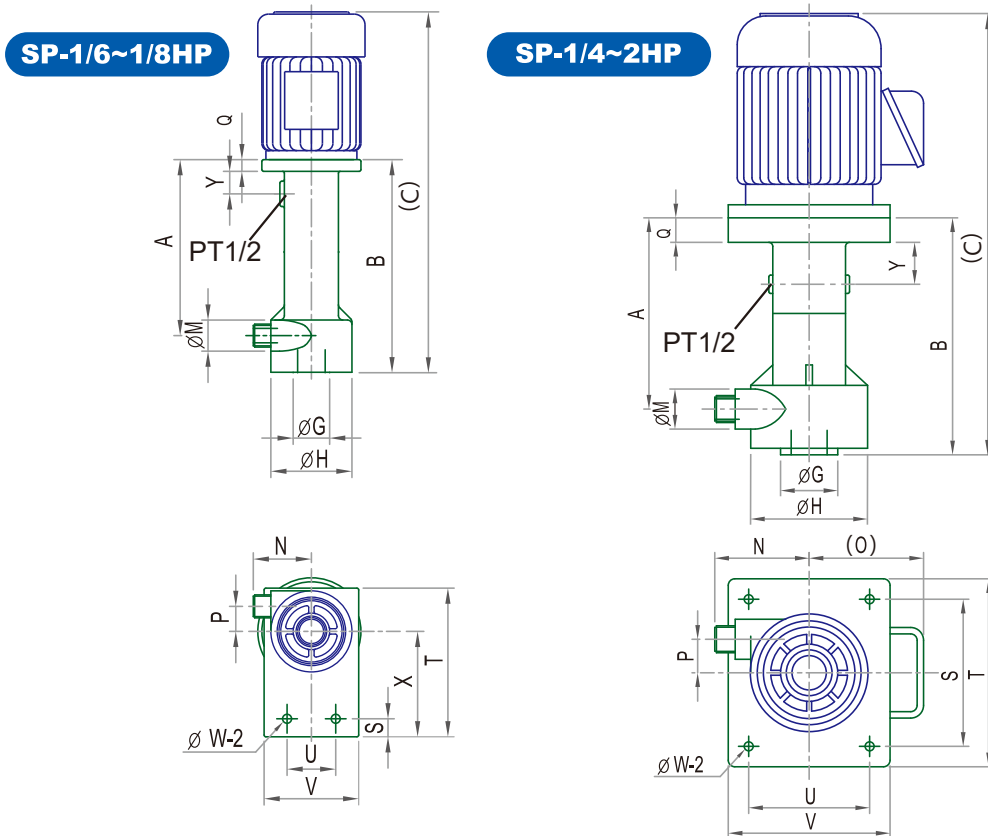

DIMENSION 尺寸表

Unit (單位):mm

MODEL	A	B	(C)	G	H	M	N	(O)	P	Q	S	T	U	V	W	X	Y
20SK-1/8	195	236	401	40	90	33	64.5		30	14	20	165	54	109	10	117	36
20SK/SP-1/6	195	236	401	40	90	33	64.5		30	14	20	165	54	109	10	117	36
20SK-1/4	260	302	562	42	110	43	100	142	35	18	150	182	150	182	10		53.5
25SK/SP-1/3	260	302	562	42	110	43	100	142	35	18	150	182	150	182	10		53.5
25SK-1/2	234	293	578	70	144	49	115	153	41	30	180	230	150	198	15		30.5
25SP-1	234	293	578	70	144	49	115	153	41	30	180	230	150	198	15		30.5
40SK/SP-1	234	293	578	70	144	49	115	153	41	30	180	230	150	198	15		30.5
40SK/SP-2	234	293	608	70	144	49	115	153	41	30	180	230	150	198	15		30.5
40SL-1/2	234	297	582	70	168	49	126	153	49	31	180	249	150	216	15		30.5

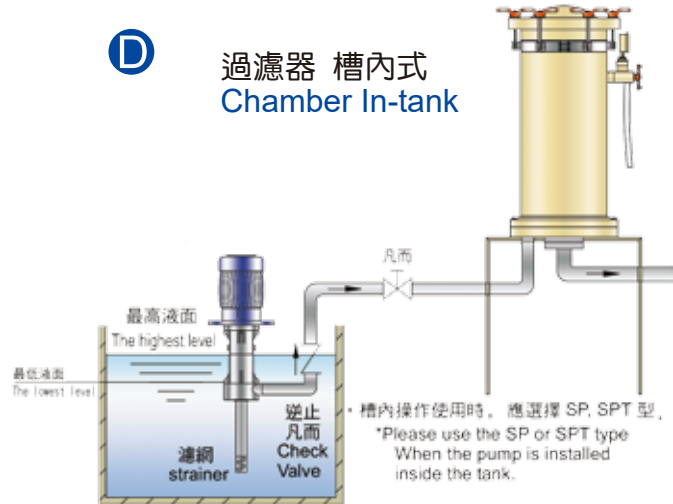
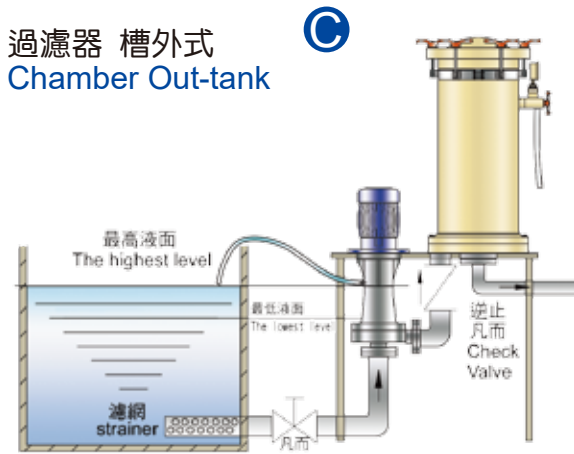
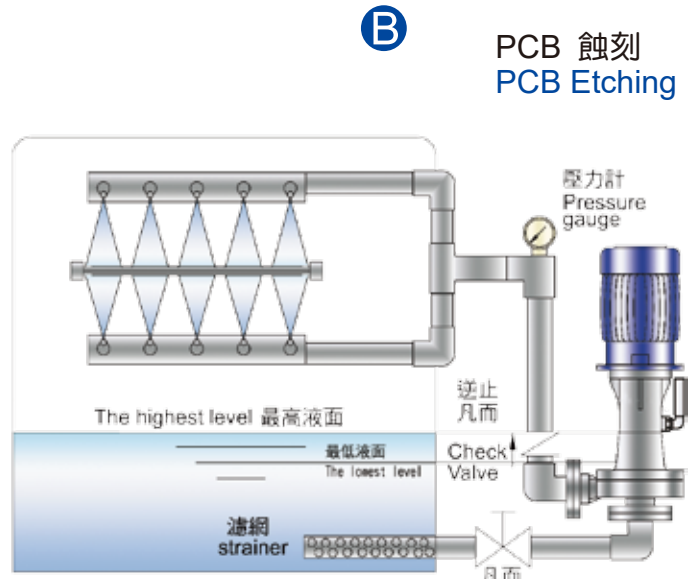
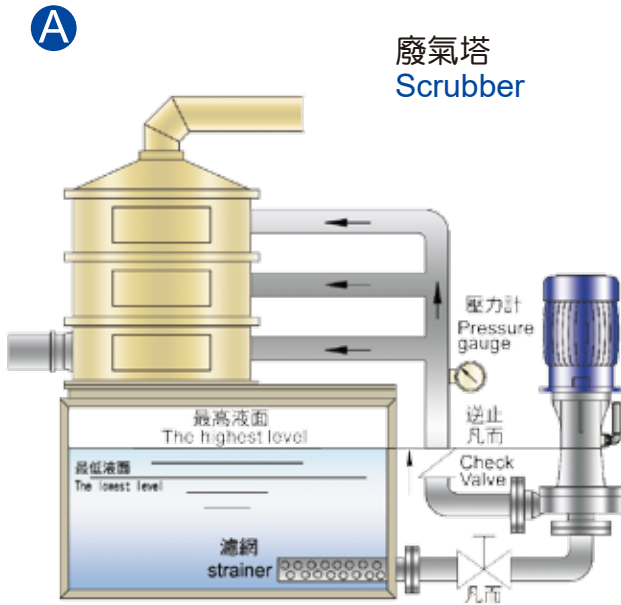

Cautions:

1. Set a check valve at the outlet of the pump if the outlet pipeline is higher than the pump and may cause back flow. Do not put the check valve higher than the highest liquid level in tank too much.
2. Set a strainer at the end of inlet to keep the pump from being damaged by impurities. (The total mesh area of the strainer should be 5 time the pipe area or more.)
3. Please contact our technician if any special demand required. For example, anti-explosion motor.
4. Motor should be anti-corrosion coated for special corrodent environment.
5. When operating two vertical pumps simultaneously, make sure each pump has its own inlet and outlet without sharing. Failure to follow this instruction can cause pump failure and poor efficiency. In the worst situation, this inlet/outlet sharing can cause permanent damage to the pump.

注意事項：

1. 出口配管高度，如有高過馬達以上或有逆壓之情形時，請在泵浦出口處裝置逆止閥，裝置位置請勿超過最高液面線太高。
2. 入口處為安全起見，最好裝置過濾網以免吸入雜物損壞泵浦。(濾網孔面積約直徑5倍以上)
3. 在特殊環境下使用時，如需安裝防爆或耐壓防爆之馬達時，請與本公司技術人員商談。
4. 在含有化學氣體之環境下使用時，必需選擇特殊處理有防蝕漆之馬達。
5. 兩台立式泵浦同時運轉，不能共用一支出入口管路，會影響泵浦壽命及性能，嚴重會造成損壞。



逆止凡而
PP / PVC
Check Valve



入口濾網
PP / PVC
Inlet Strainer

入口三通濾網
PP / PVC Tee Inlet Strainer



EXAMPLES
應用範例

E

以下為不正確安裝方式
Please don't use pumps like this!

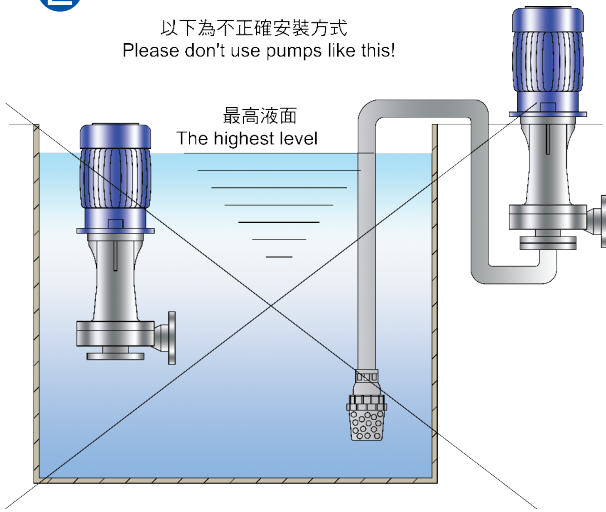

F 立式泵移槽循環

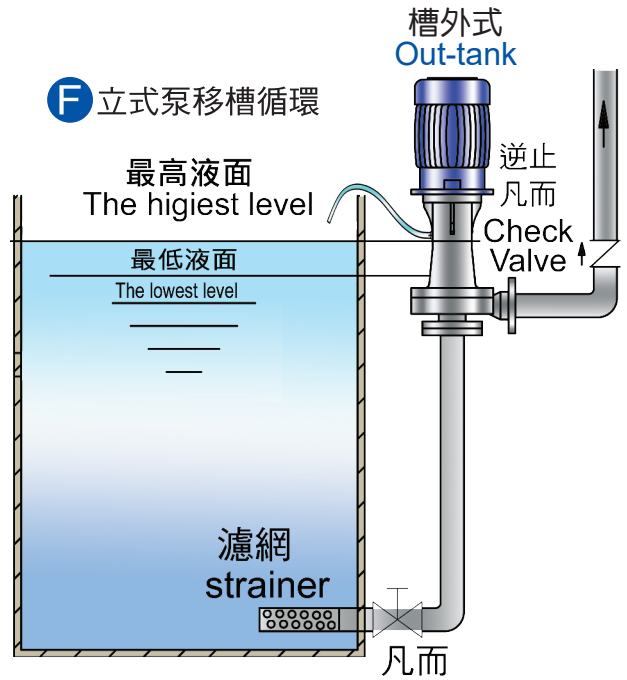

G

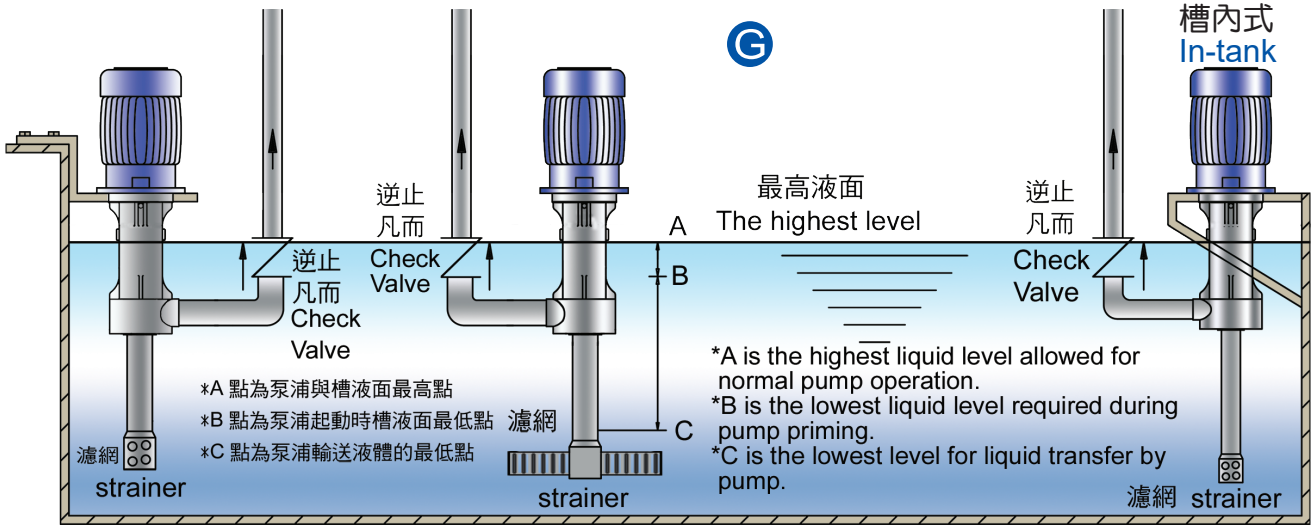

※ 濾網孔面積須大於管徑5倍以上

配件 Accessories



PVC / EPDM / VITON
擺動式逆止閥
Swing check valve

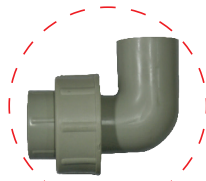

SP / SPT 出口彎頭
PP / CPVC / CFRPP / PVDF
SP / SPT Elbow Union



PVC / PP 底閥
PVC / PP Foot Valve

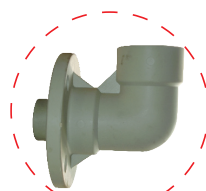

TD / 出口逆止彎頭
PP / PVC



SPT / TD 機型

FRP 座 / FRP Base
for SPT / TD series.

TD1~5HP
長540mm寬340mm高670mm
TD7.5~10HP
長550mm寬440mm高730mm



總公司

昇展實業股份有限公司

台灣省台南市永康區中正南路404巷7號

Tel: 886-6-2534546, 2541601

Fax: 886-6-2534226, 2420509

SUPER GIANT ENTERPRISE CO., LTD.
No.7, Lane 404, Chung Cheng South Road, Yen
Hang, Yung Kang, Tainan, Taiwan,

Tel: 886-6-2534546, 2541601

Fax: 886-6-2534226, 2420509

E-mail: super@superpump.tw

Website: www.superpump.tw

www.chemicalfilter.com.cn



上海區 塑寶環保機械

江蘇省太倉市沙溪鎮岳王區

鎮北路16號 215400

Tel: 0512-53303388, 53303398

Fax: 0512-53303588

E-mail: taichang@superpump.cn

Website: www.superpump.cn

廣東區 升展機械

廣東省廣州市增城區新塘鎮

民營西二路9號

(遠航科技園B1座二樓)

Tel: 020-82691835, 82602341~3

Fax: 020-82708706

E-mail: singtown@superpump.cn

Website: www.chemicalpump.cn

訂購時請提供下列資料:

1. 藥液條件: 名稱_____/溫度_____
濃度_____/比重_____/黏度_____
2. 需求流量: _____ L/min
3. 需求揚程: _____ M
4. 馬達: 電壓/頻率

While placing your order...

Please kindly provide us the following information.

1. Chemical: Name_____/Concentration_____
Temperature_____/Specific Gravity_____
Viscosity_____
2. Capacity needed: _____ L/min
3. Head needed: _____ M
4. Power: Voltage/Frequency